

STM Load Cell

S-Type Load Cell

- Maximum capacity (E_{max}) (kg):
2, 5, 10, 20, 50
- Be suitable for a wide range of applications including testing or weighing systems, and it can be put into the device, in order to monitor the force.



Dimensions(mm)

2kg...10kg

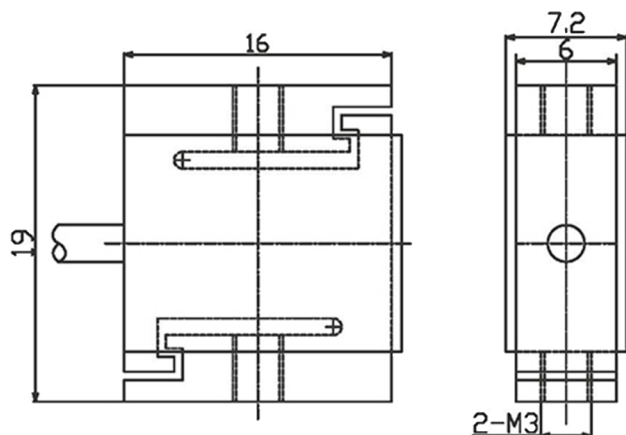

10kg...50kg

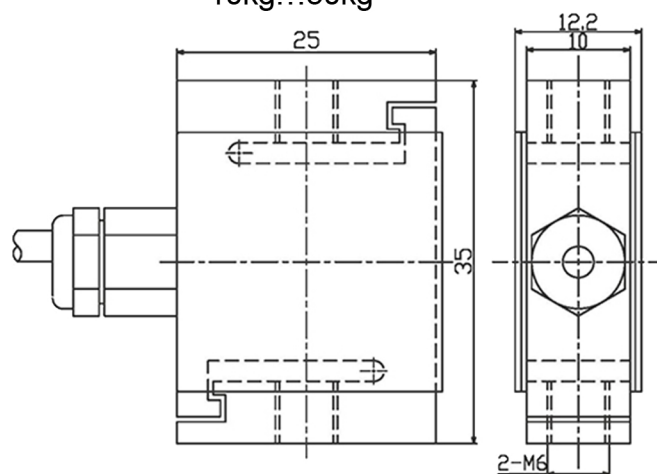

Specifications

Rated Load	kg	2, 5, 10, 20, 50
Rated Output	mV/V	1(2kg),2(5kg~50kg)
Zero Balance	%R.O.	±2
Comprehensive Error	%R.O.	±0.05
Recommend edexcitation voltage	VDC	5-12 /15(max)
Input impedance	Ω	350±5
Output impedance	Ω	350±3
Insulation resistance	MΩ	≥5000 (50VDC)
Safe overload	%R.C.	150
Ultimate overload	%R.C.	300
Material		Stainless Steel
Degree of protection		IP66