

Aluminum alloy single point load cell

Features

- Product features
- Weighing range: 2kg
- Compact size, stable performance
- Simple structure, easy to install
- Aluminum alloy material, anodized surface

Application

- Narrow spaces
- Robotic arms
- Kitchen scales

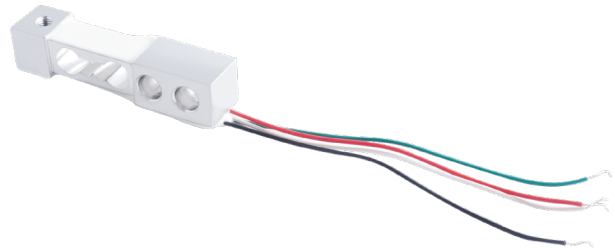

Description

The 4510 sensor is a miniature single-point sensor with compact size and stable performance, suitable for weighing and force measurement in various narrow spaces.

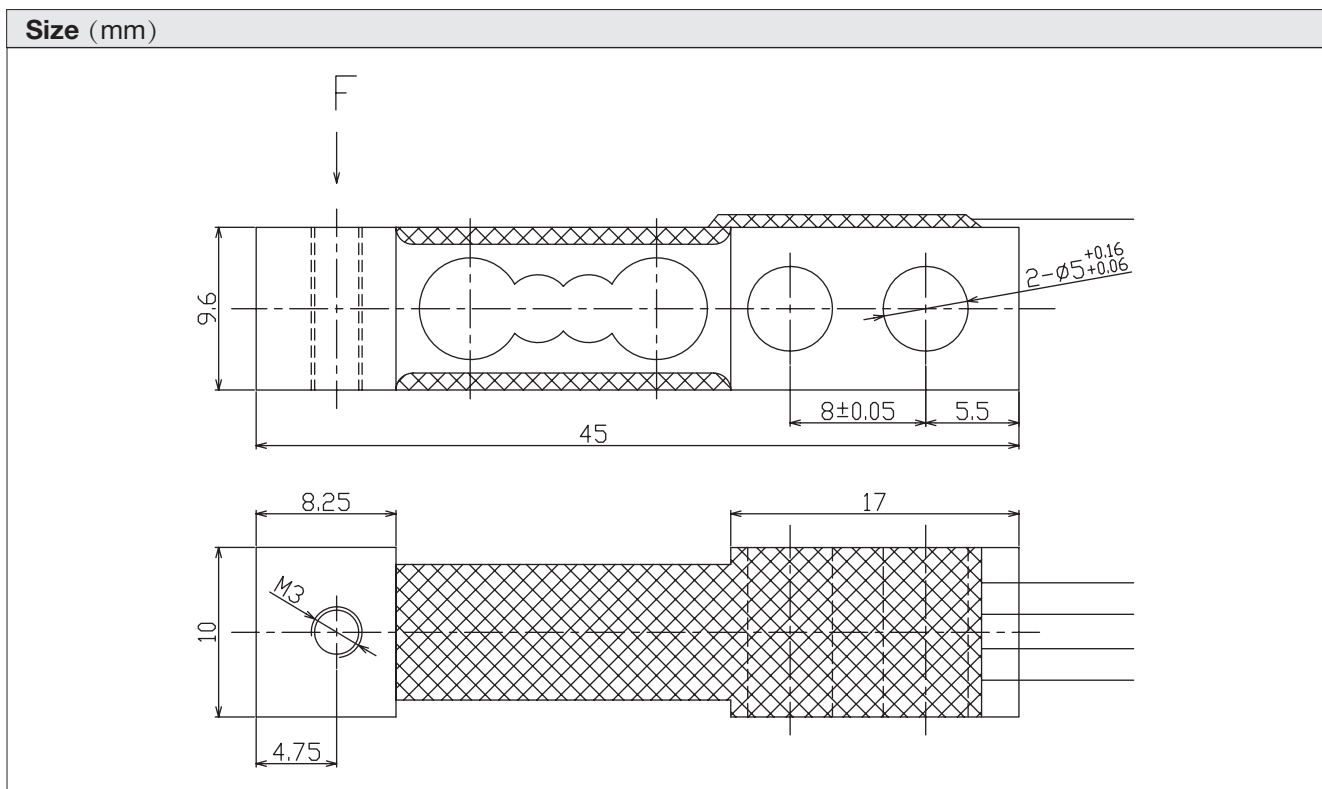

4510 single point load cell

Product specifications		
参数	Value	Unit
额定载荷	2	kg
额定输出	2.0±0.2	mV/V
非线性	≤0.05	%R.O.
零点输出	±0.05	mV/V
重复性	< ±0.05	%R.O.
蠕变 (30 分钟)	±0.05	%R.O.
正常工作温度范围	-10~+40	°C
允许工作温度范围	-20~+70	°C
推荐激励电压	5-12	VDC
输入阻抗	1000±10	Ω
输出阻抗	1000±5	Ω
绝缘阻抗	≥3000 (50VDC)	MΩ
安全过载	150	%R.C.
极限过载	200	%R.C.
弹性元件材料	Aluminum	
防护等级	IP65	
电缆线长度	75	m

Product specifications are subject to change without notice.

Wiring

